

New Sydney Fish Market

Community notification

Night works, temporary road and footpath changes

3 March 2022

Dear Neighbour

The NSW Government is delivering a new Sydney Fish Market which will retain its authentic experience and strengthen its position as one of Australia's leading tourist destinations.

Update – Temporary substation kiosk installation works – weather delay

As previously notified, work to complete the installation of a temporary substation kiosk and associated cabling that will provide power for the construction site is continuing.

Due to ongoing inclement weather, a further four nights are required for the completion of works:

Night works to install the temporary substation kiosk will continue and occur on:

- **Monday 7th March and Tuesday 8th March starting at 9pm**
- **Monday 14th March and Tuesday 15th March starting at 9pm**
Work shifts finish at 5am the following morning.
Work shifts may commence earlier than 9pm in the evening subject to authority approvals

Day works will be undertaken along the southern Bridge Road footpath on:

- **Monday 14th March and Tuesday 15th March from 12pm** to prepare for cable pulling works in the following night shifts. The footpath will be closed, with traffic control to guide pedestrians to an alternative pedestrian route (refer Figure 2).

Should the weather cause further cancellations, day and night works will continue on the following dates:

- Monday 21st March and Tuesday 22nd March starting at 12pm
- Monday 21st March and Tuesday 22nd March starting at 9pm
- Monday 28th March and Tuesday 29th March starting at 12pm
- Monday 28th March and Tuesday 29th March starting at 9pm



- » Email nsm.community@multiplex.global
- » Visit insw.com/newsydneyfishmarket
- » Call 1800 271 114

Works have been scheduled as night works along Bridge Road due to the disruptive nature of the work to traffic and pedestrians and in consideration for public safety. Where possible day works are undertaken during approved construction hours along the southern Bridge Road footpath to minimise impact to local residents. During this period, adequate traffic control measures will be in place.

It is noted that these dates are subject to change pending further inclement weather and authority approvals.

How this affects you

The location for these works is in the traffic lanes and footpaths along Bridge Road between Glebe Foreshore Walk and Wentworth Park Road. See the diagram below for the work locations.

During this time, the following measures will be in place:

- Guiding vehicles and cyclists along the work zone with traffic control and signage. There will be closure of up to two lanes depending on the stage of work.
- Providing alternative pedestrian routes with traffic control guidance. Footpaths will be maintained during works where possible, while temporary pedestrian crossings will be set up and managed by traffic controllers to safely guide pedestrians across the road.

The work zones will be removed at the end of each shift, and travel along the road and footpath will continue as normal outside the construction hours. Steel plates will be installed over incomplete work outside of shift hours.

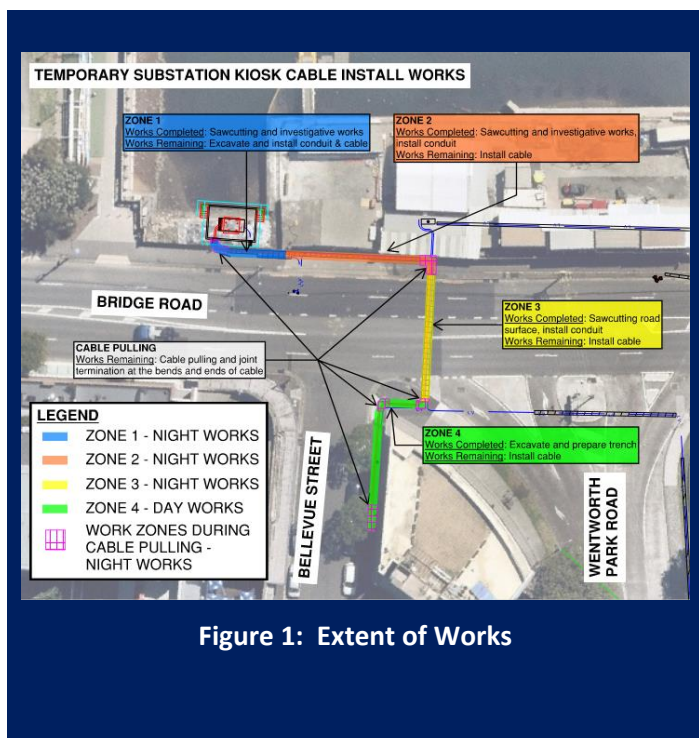

Figure 1: Extent of Works

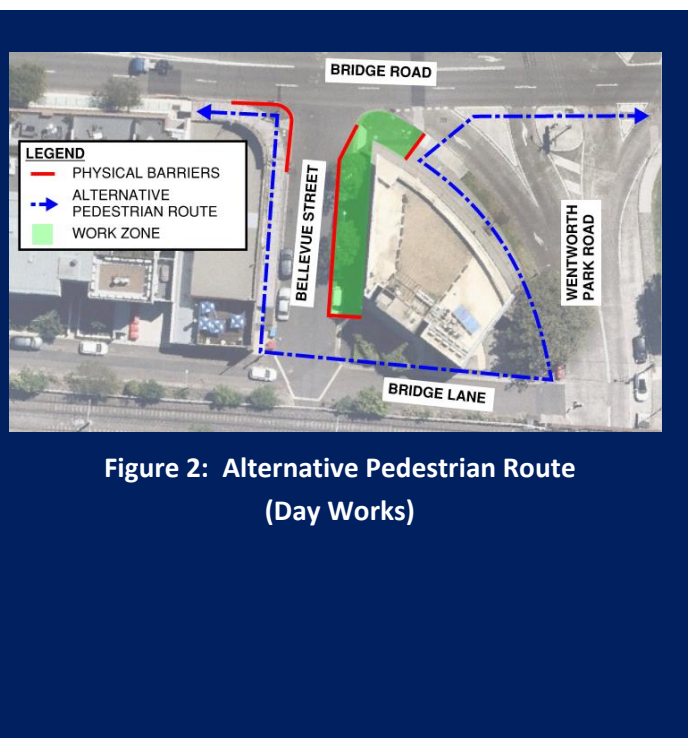

Figure 2: Alternative Pedestrian Route (Day Works)

We understand the potential impacts this may cause to the local community and thank you for your understanding during this work.



- » Email nsm.community@multiplex.global
- » Visit insw.com/newsydneyfishmarket
- » Call 1800 271 114

If you have any questions or concerns, please don't hesitate to contact us on 1800 271 114. If you would like to receive project updates by email, please let us know.



If you need help understanding this information, please contact the Translating and Interpreting Service on 131 450 and ask them to call us on 1800 271 114.